

Three looks for

LIVING ROOM FLOORING

We've created inspirational schemes using over-sized wooden boards, a sophisticated striped carpet and dark felt with studwork

STYLING KATRIN CARGILL
PHOTOGRAPHS PAUL RAESIDE

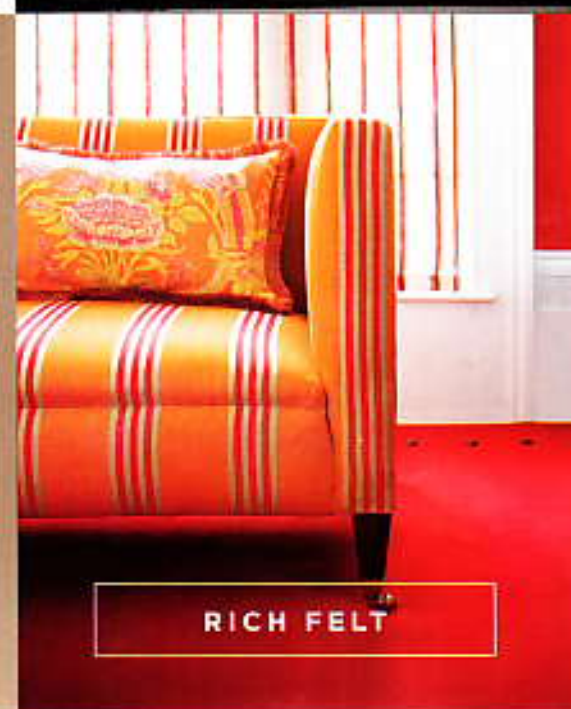

CHIC STRIPES



A bold striped two-tone wool carpet needs careful pairing with similarly coloured fabrics and accessories. The deep aqua paint on the walls calms the scheme, while adding warmth and colour. Linking the whole look, wide grosgrain ribbon edging frames the large pattern of the curtain fabric while echoing the stripes of the carpet and chair.





FLOORING Wool Blocstripe 1852 in Sable/Bone, wool, 4m wide, £44.50sq m, The Alternative Flooring Company.

FURNITURE Antique

Anglo-Indian rosewood sunburst cupboard, H201xW124xD55cm, £3,800, Guinevere Warehouse.

Ille Club sofa, H66xW215xD94cm, £3,340, Piero Lissoni at Aram.

Tribal carved wood low table, H48xdiam97cm, £1,500, Guinevere Warehouse.

Antique striped armchair, H86xW79xD92cm, £1,400, A&L Antiques.

Anglo-Indian Padouk table (on page 89), H61xW35xD35cm, £4,200 pair, Soane.

FABRIC Curtains In Anis in Nori, linen, 143cm wide, £42.95m, Romo. Edged In Grosgrain 13, 57mm wide, £7.60m, Abbott & Boyd.

Blind In Durance Embroidery 55691 in Truffle, linen/cotton/polyester mix, 133cm wide, £168m, Matthew Smyth for Schumacher at Turnell & Gigon.

Edged In Grosgrain 113, 52mm wide, £3.20m, V V Rouleaux.

Cushions In Katana GWF2812-616, linen, 137cm wide, £90m, Kelly Wearstler for Lee Jofa at GP&J Baker.

WALLS Arsenic, Estate Emulsion, £26 for 2.5 litres, Farrow & Ball.

ACCESSORIES Alaska floor lamp, H172cm, £1,445, Roche Bobois.

Raku ceramic bowl with sunrise centre, H23xdiam40cm, £850, Catriona McLeod at Talisman.

Books, from £25 each, The Conran Shop.

Broad Stripe wool throw in Chocolate, 122x183cm, £85, Melin Tregwynt.

Bamboo lanterns, H32xdiam38cm, £26 each, Oka.

Green mosaic jug (on page 89), H26xdiam20cm, £550, Stephen Wright at Wild at Heart. ▶



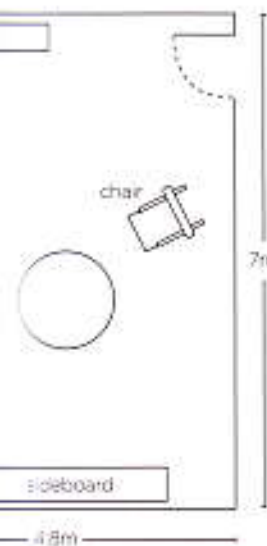

HOW TO MAKE IT WORK

- A bold stripe laid horizontally helps the room appear wider.
- This whimsical inlaid cupboard acts as a decorative foil to the carpet, while continuing the two-tone theme.
- The curves of the Pretzel chair add renewed interest to the stripes.

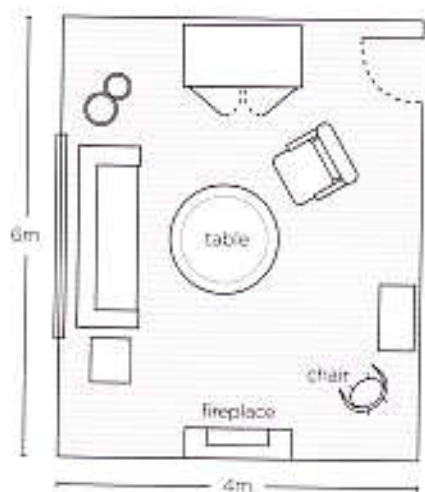

HOW TO MAKE IT WORK

- Felt wool floor to mask uneven walls.
- An oriental pattern toning shades a red wall.
- Red walls and a canvas for multi-

chair at Tumell & Gigon.
FRISCO Pressed-flower print
 organic. **FRISCO** lamp, H53cm,
 at The Corner.
PAPERWEIGHT, diam17.5cm,
GOBLET, E25, The Dining Room
 £90, Daylesford Organic.

FLOORING Wool Bloecstripe 1852
 in Seale Stone, 100cm wide, £44.50sq m,
 The Artistic Flooring Company.
FURNITURE Ikebana two-door
 cupboard - H110xW88xD35cm, £875, Graham
 & Green. **George Nelson Pretzel chair**,
 H70xW67xD45cm, £1520, Vitra at Aram.

WALLS Arsenic, Estate Emulsion,
 E26 for 2.5 litres, Farrow & Ball.
ACCESSORIES Coral vase, H32x
 W20cm, £175, Rina Menardi at Wild at Heart.

FLOORING Tap
 wool/cotton mix, 1400
 Dates Design. **Antique**
 £650, Tobias Arts The
FURNITURE
 H76xW120xD60cm, £1
 H97xW50xD64cm, £10